



PTS 31



THE NEXT STEP IN BOATING PLEASURE

PTS 31

The PTS 31 is proof that eye-catching design and optimum functionality are the perfect combination. In this Vripack design, the family bond with our PTS 26 can be easily recognized and yet the boat most certainly has its own character. Much attention has been paid during development to the most effective use of space: Hence the helm and passenger seating is designed in such a way that they can be transformed into 2 benches in no time. The cabin has headroom and is light and airy thanks to a large glass roof hatch that can be opened. The galley and the wet room are spacious and

beautifully styled. The interior is modular to accommodate the specific wishes of the new owner. The underwater hull shape is semi-planing, which means that manoeuvring is excellent at both higher and low speeds. The ship has a playful character due to a glass mirror aft that can be opened at the push of a button to allow aft access onto a pontoon from the stern in addition to the usual side access. Seeing the water through the stern also increases the on-the-water experience. The low maintenance materials include Esthec deck as standard leaving you more time to cruise.



TAILOR-MADE FOR YOU

The PTS 31 is being built in Schagen, an hour from Schipol International airport, by a permanent team of young, skilled and motivated employees. In consultation with the future owner, the boats are built to your individual specification with regard to the colour of the hull, cushions, hood, waterline,

seating and even deck covering. Each PTS 31 is tailor-made to order and as a new owner you will be very welcome to visit at any time to monitor progress on site. A trial run is of course also possible in advance of making a commitment! Please call the yard or one of our agents to make an appointment today.

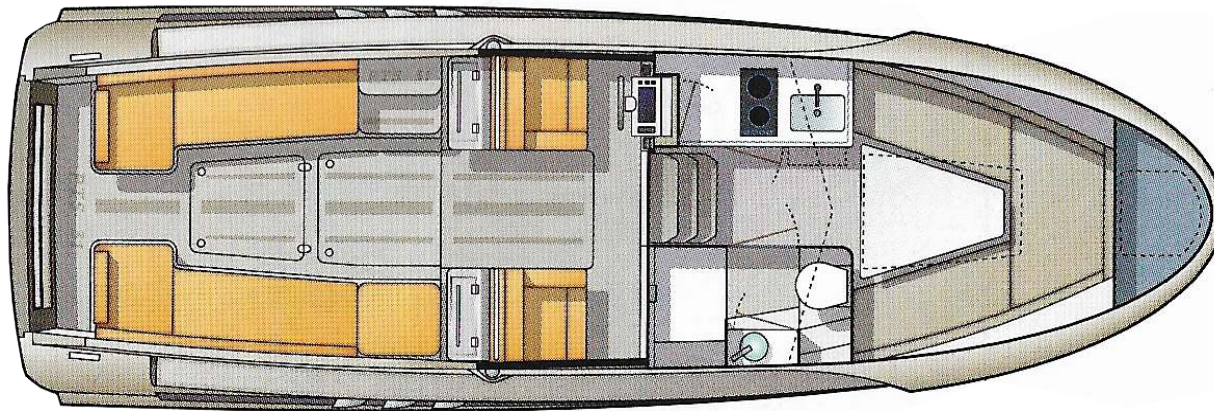

SPECIFICATIONS

| | |
|---------------------------|--------------------------------------|
| DESIGN | Vripack Naval Architects |
| LENGTH OVERALL | 9,50 metre (31 feet) |
| BEAM | 2,98 metre (9,8 feet) |
| DRAFT | 0,90 metre (3 feet) |
| HEIGHT ABOVE WATERLINE | 2,25 metre (7,4 feet) |
| HEADROOM CABIN | 1,90 meter (6,3 feet) |
| DISPLACEMENT | 4.950 kg (aprox.) |
| CERTIFICATION CE category | C; coastal waters, 8 persons |
| STANDARD ENGINE | 75 HP Steyr 4 cylinder diesel |
| OTHER ENGINES | 144 HP Steyr up to 279 HP 6 cilinder |
| TOP SPEED | depending on engine 8 to 25 knots |
| AVAILABLE IN | all RAL colours |
| MATERIAL | polyester, sandwich |
| NUMBER OF BEDS | 4 + 2 |
| PRODUCED BY | Statement Marine, The Netherlands |
| TANKS DIESEL | 319 L |
| TANKS WATER | 178 L |
| TANK BLACK WATER | 60 L |
| BOILER | 40 L |

Agent UK

HENLEY SALES & CHARTER LTD

5 Friday Street

Henley-on-Thames, Oxfordshire

RG9 1AN

Sales: 01491-578 870

E-mail: office@hscboats.co.uk

SHIPYARD STATEMENT MARINE

Lagedijkerweg 4

1742 NB SCHAGEN

Tel: +31-6-106 138 73

E-mail: info@statementmarine.nl

www.statementmarine.nl

FULLY EQUIPPED

With the PTS 31 you can enjoy day cruising and also weeks away from land on vacation. Four berths and the extra possibility for two sleeping places in the cockpit make the boat suitable for extended cruising.

STANDARD SPECIFICATION

- Esthec Deck both inside and outside
- Bow thruster 75 kgf
- Electrically operated forward seating
- Front seats can be widened to 1.5 bench seating
- Electrically operated folding mirror
- Large skylight/hatch in the forward deck
- 12 inch Raymarine Axiom screen 12
- Choice of Silverguard or Sunbrella fabric cushions
- Swivel table in the cockpit
- 2 burner electric hob
- Sink with mixer tap
- Fridge with freezer
- Electric toilet
- Spacious and separate rain shower
- Mastervolt 1600 watt inverter
- Shore power connection
- Designer steering wheel which blends seamlessly with the dashboard
- Fell Marine cordless dead man's button
- Hydraulic engine hatch

